

26/00230/S73

Land West Of, Hither Green Lane, Redditch,  
Worcestershire, B98 9AZ

Variation of condition 16 attached to 21/01830/FUL  
(approved under appeal ref:  
APP/Q1825/W/24/3350905)

Recommendation: Minded to GRANT subject to  
conditions

# Variation of condition 16 attached to 21/01830/FUL (approved under appeal ref: APP/Q1825/W/24/3350905)

FROM: None of the dwellings hereby permitted shall be occupied until the highway improvements to the Dagnell End Road / A441 Birmingham Road junction as shown in the PJA Drawing Ref: 2809 P 12 Rev P4 (planning permission ref: 19/00976/HYB) have been approved in writing and completed to the satisfaction of the Local Planning Authority and is open to traffic. The junction is to include Microprocessor Optimised Vehicle Actuation (MOVA) signal control.

AMEND TO: Prior to the occupation of the 101st dwelling, the highway improvements to the Dagnell End Road / A441 Birmingham Road junction as shown in the PJA Drawing Ref: 2809 P 12 Rev P4 (planning permission ref: 19/00976/HYB) shall have been approved in writing and completed to the satisfaction of the Local Planning Authority and is open to traffic. The junction is to include Microprocessor Optimised Vehicle Actuation (MOVA) signal control.

# Site Location Plan

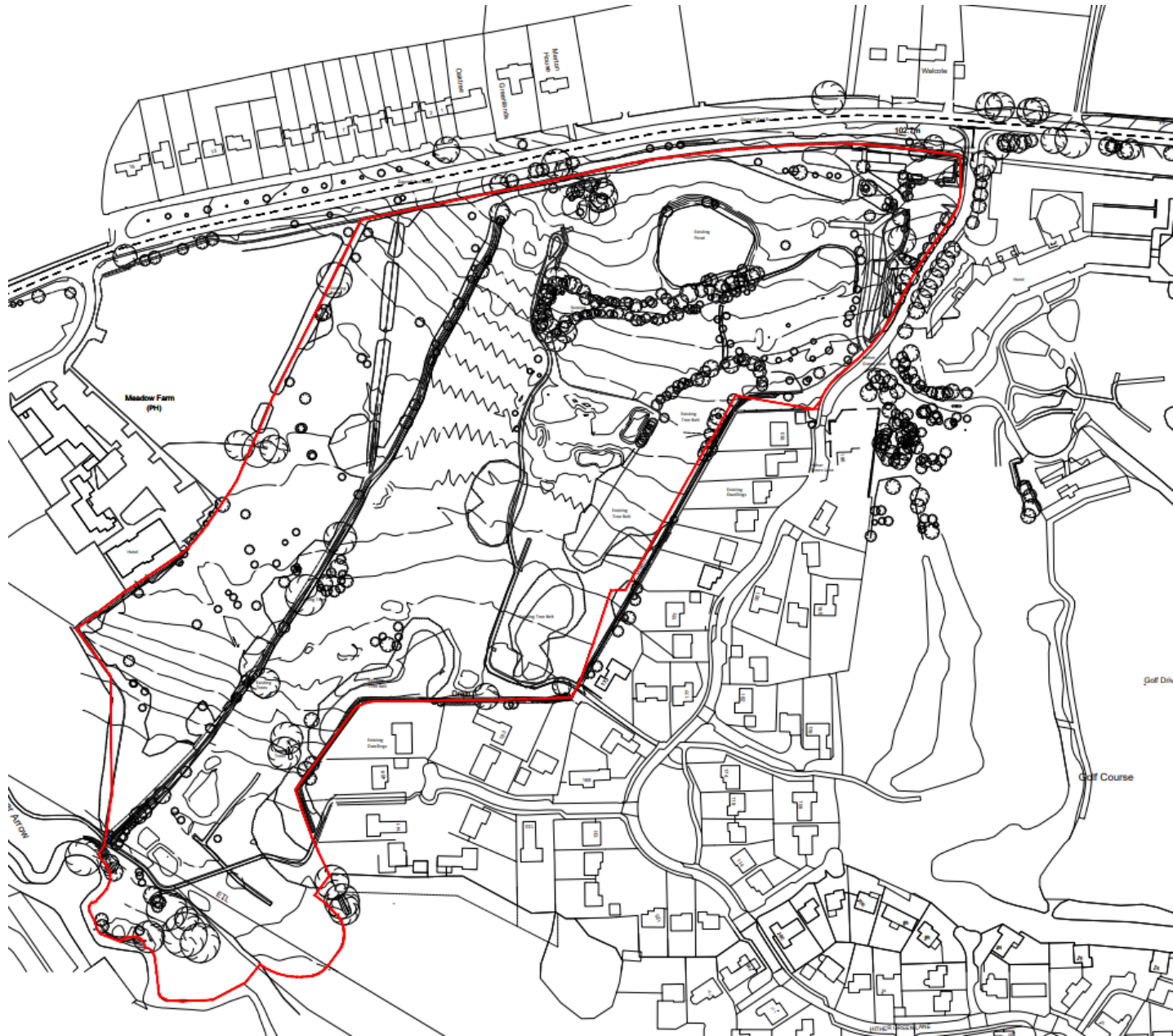

# Approved Signalised Junction Improvements - PJA Drawing Ref: 2809 P 12 Rev P4

